

## FIREPLACE KIT SYSTEM FROM BRUNNER



### **BSK 12 with Kamin- Kessel Eck 42/57/30 side-opening door**

State: 2018-04-30



**BRUNNER**<sup>®</sup>  
*made in germany.*

# Dimension sheets - BSK 12 with Kamin-Kessel Eck 42/57/30 side-opening door

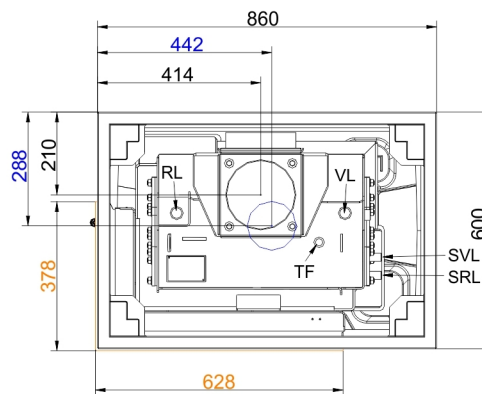
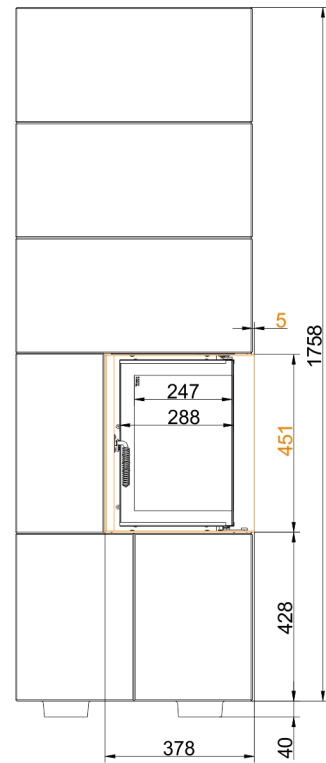
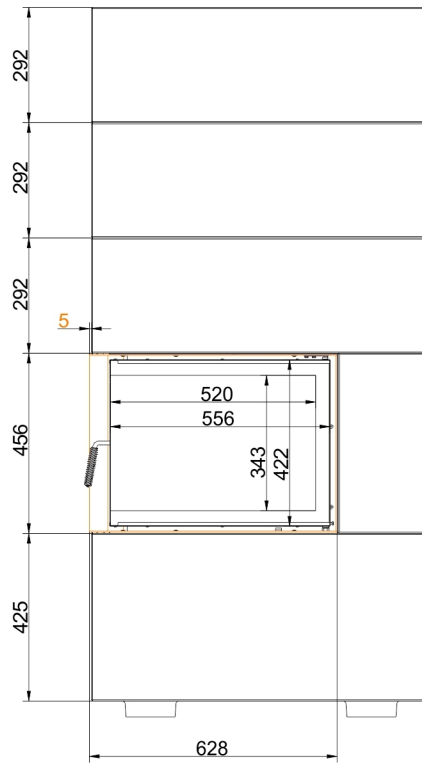
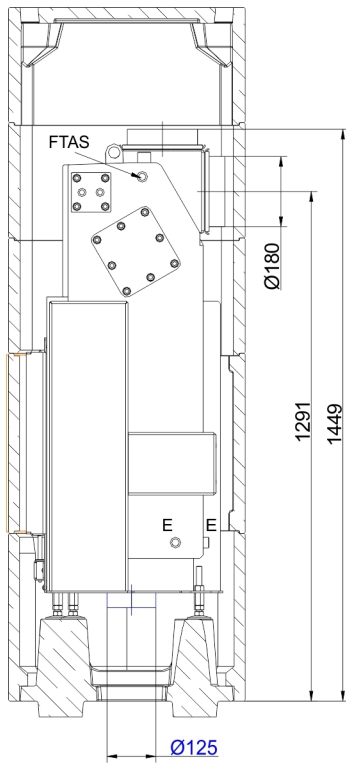
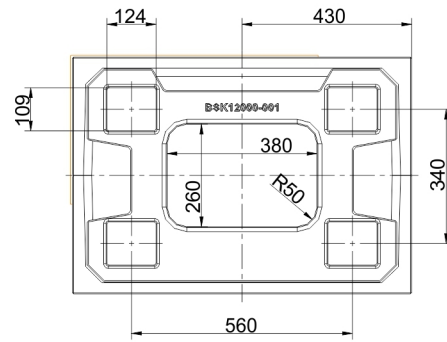

- VL supply 1"ext. th.
- RL return boiler 1"ext.th.
- E drain 1/2"int. th.
- SVL supply cooling pipe outlet ext.th.
- SRL return cooling pipe outlet 1/2"ext.th.
- FTAS socket for thermal safety sensor int.th.
- TF socket 1/2" for sensor int.th.

... left

# Dimension sheets - BSK 12 with Kamin-Kessel Eck 42/57/30 side-opening door

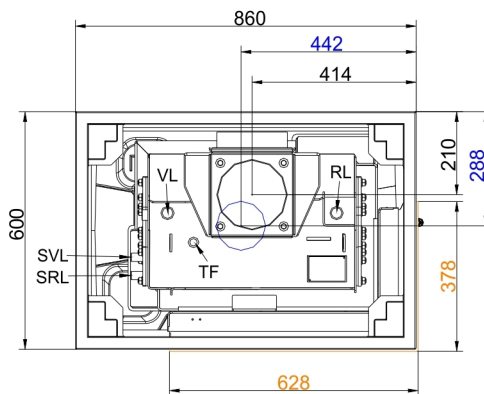
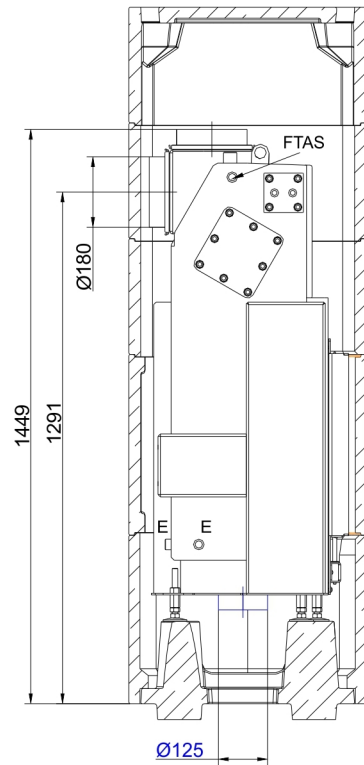
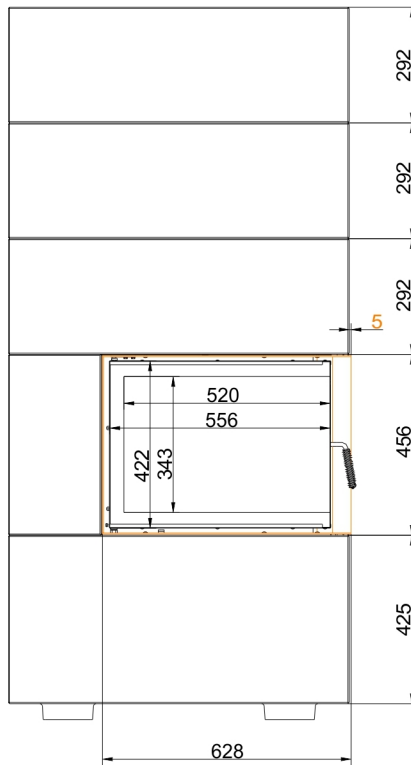
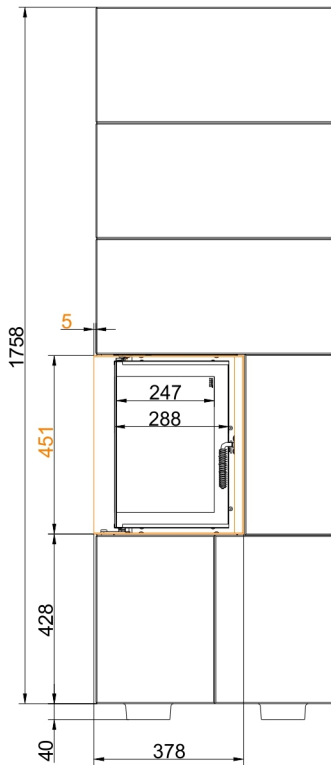
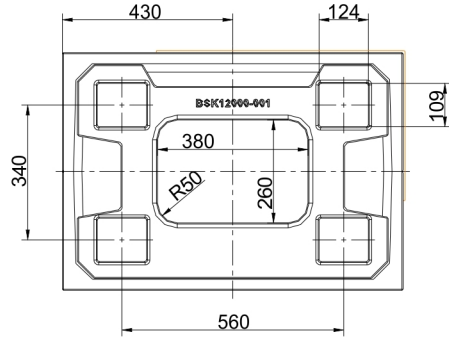

- VL supply 1"ext. th.
- RL return boiler 1"ext.th.
- E drain 1/2"int. th.
- SVL supply cooling pipe outlet ext.th.
- SRL return cooling pipe outlet 1/2"ext.th.
- FTAS socket for thermal safety sensor int.th.
- TF socket 1/2" for sensor int.th.

... right

We suggest for CAD planing Palette CAD. Permanent updated drawings: [www.brunner.de](http://www.brunner.de)  
 Frames / front versions are marked colored.

## Planning and installation - BSK 12 with Kamin-Kessel Eck 42/57/30 side-opening door

Tested according to		EN 13229
EEL		109.9
<b>Data for functional demonstration</b>		
Rated heat power	kW	8
Fire wood volume	kg/h	2.5
Flue gas mass flow	g/s	9
Flue gas temperature	°C	175
Necessary supply pressure <sup>1)</sup>	Pa	12
Combustion air consumption	m <sup>3</sup> /h	25
Combustion air connection Ø	mm	125
<b>Cladding components</b>		
Foot print (W x D)	mm	800 x 600
Overall height	mm	1798
Height of extension ring	mm	292
<b>Minimal distances</b>		
to mounting wall	cm	5
to mounting wall with heat protection panels	cm	0
to combustible mounting wall	cm	10
to combustible mounting wall with heat protection panels	cm	5
from top of fireplace to ceiling	cm	40
<b>Cross-section of gratings <sup>2)</sup></b>		
Convection air	cm <sup>2</sup>	906
Supply air	cm <sup>2</sup>	1264
<b>Thermal insulation without / with air gratings</b>		
In ceiling region connection without/with air grate	cm	10 / 10
<b>Weight</b>		
Total weight	kg	551
<b>Meets requirement/limit values for:</b>		
Germany/ Austria / Suisse / Norway		1.BImSchV (Stufe 2) / 15a BvG (2015) / LRV / -

1) Damper flap recommended

2) Openings for the air